

Re-imagining lecture theatres

Concept cards

Created by Loren Taylor and Dr Hiral Patel

Collaborative Tiered Seating

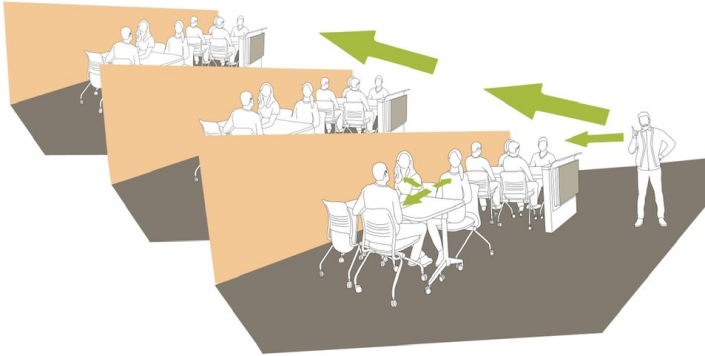

Pros

- The flexible seating allows students to work more collaboratively.
- Lecturers can move between the desks and interact with students.
- Spatially more accessible tiered layout.

Cons

- The cost Implications of removing existing seating and replacing it.
- Could accommodate a drastically smaller student capacity.

Extent of intervention to built structure
Extent of intervention to digital infrastructure
Extent of intervention to space management
Extent of flexibility for different teaching styles
Extent of flexibility for different uses by students

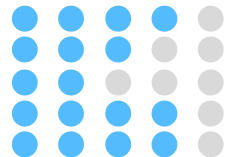

Flat Floor Seating



Pros

- The flexible seating allows students to work more collaboratively.
- Could be used for multiple purposes.
- Spatially more accessible layout without stairs.

Cons

- Cost implications of complete refurbishment.
- Accommodates a smaller capacity.
- Inappropriate A/V and electrical sockets could cause barriers for multiple uses

Extent of intervention to built structure
Extent of intervention to digital infrastructure
Extent of intervention to space management
Extent of flexibility for different teaching styles
Extent of flexibility for different uses by students

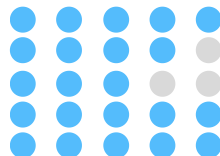

Retractable Tiered Seating

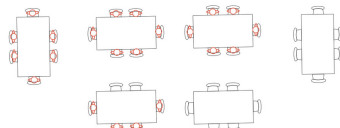
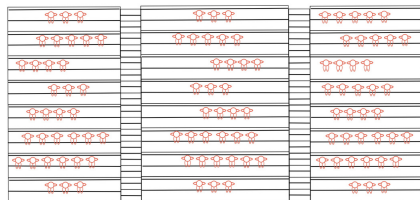

Pros

- The tiered seating can be used traditionally and then retract back to open up the space.
- The space can be used as a lecture theatre in addition to other uses.

Cons

- Cost implications of complete refurbishment/implementing new seating.
- Time needed to rearrange the space between different uses.

Extent of intervention to built structure
Extent of intervention to digital infrastructure
Extent of intervention to organisational practices
Extent of flexibility for different teaching styles
Extent of flexibility for different uses by students

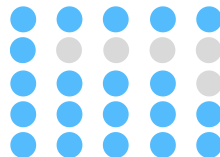

Partition Walls

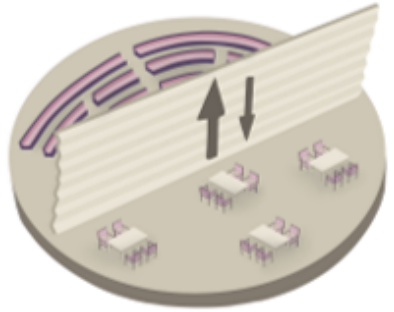
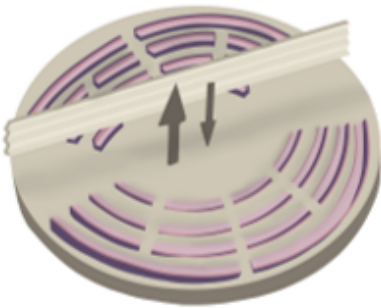

Pros

- Space can be divided/open to public use.
- Provides the option for opening or separating the space.
- Whiteboard wall finishes are available, which makes the walls multi-functional.

Cons

- Cost implications of implementing partition walls.
- The acoustic properties must be proficient enough for dividing lecture and independent learning spaces.

Extent of intervention to built structure
Extent of intervention to digital infrastructure
Extent of intervention to organisational practices
Extent of flexibility for different teaching styles
Extent of flexibility for different uses by students

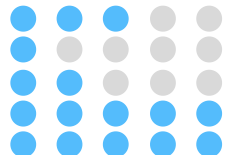

Multi-functional Spaces

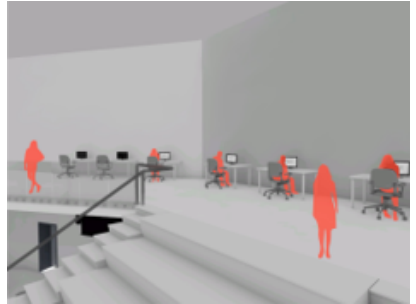

Pros

- The space wouldn't need to be partitioned, all uses in one room.
- Opportunities for independent/collaborative learning
- Can be used as a social space.

Cons

- The busy atmosphere may not be suitable/distracting for some students.
- Taking away some of the lecture seating lowers the capacity the space can hold.
- Cost implications of refurbishment.

Extent of intervention to built structure
Extent of intervention to digital infrastructure
Extent of intervention to organisational practices
Extent of flexibility for different teaching styles
Extent of flexibility for different uses by students

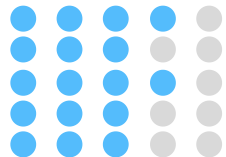

Active Learning Gardens

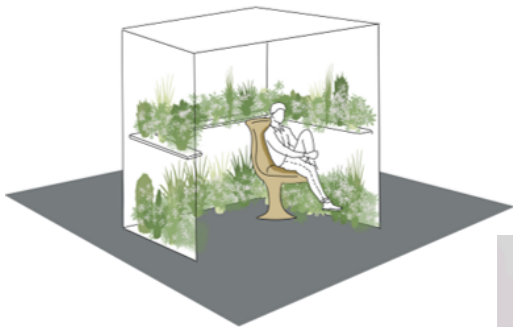

Pros

- A green space that aids better wellbeing.
- Encourages integration of nature into teaching spaces.
- Encourages students to be active while learning.

Cons

- Adding real plants may cause material moisture problems.
- May not be enough natural light within spaces.
- High costs of adding gym equipment.

Extent of intervention to built structure
Extent of intervention to digital infrastructure
Extent of intervention to organisational practices
Extent of flexibility for different teaching styles
Extent of flexibility for different uses by students

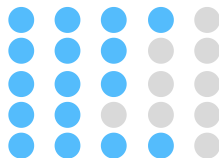

No Changes - Booking App

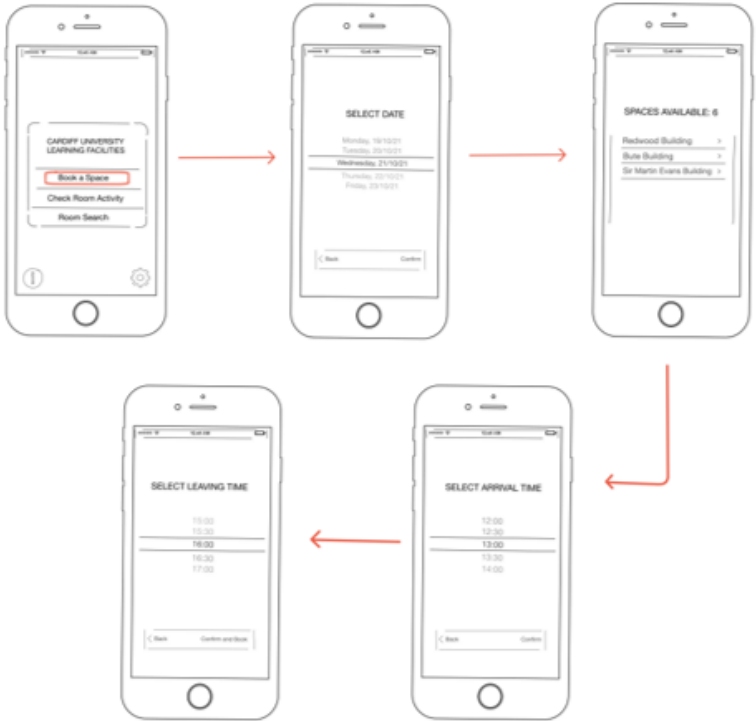

Pros

- Traditional lecture theatre design remains the same.
- Low cost implications.
- Students able to book rooms and monitor space availability.

Cons

- Little to no spatial adaptability/flexibility.
- Could encounter app problems, which prevent booking.
- students could feel reluctant to book spaces due to lack of availability.

Extent of intervention to built structure
Extent of intervention to digital infrastructure
Extent of intervention to organisational practices
Extent of flexibility for different teaching styles
Extent of flexibility for different uses by students

